

GRIMES COUNTY

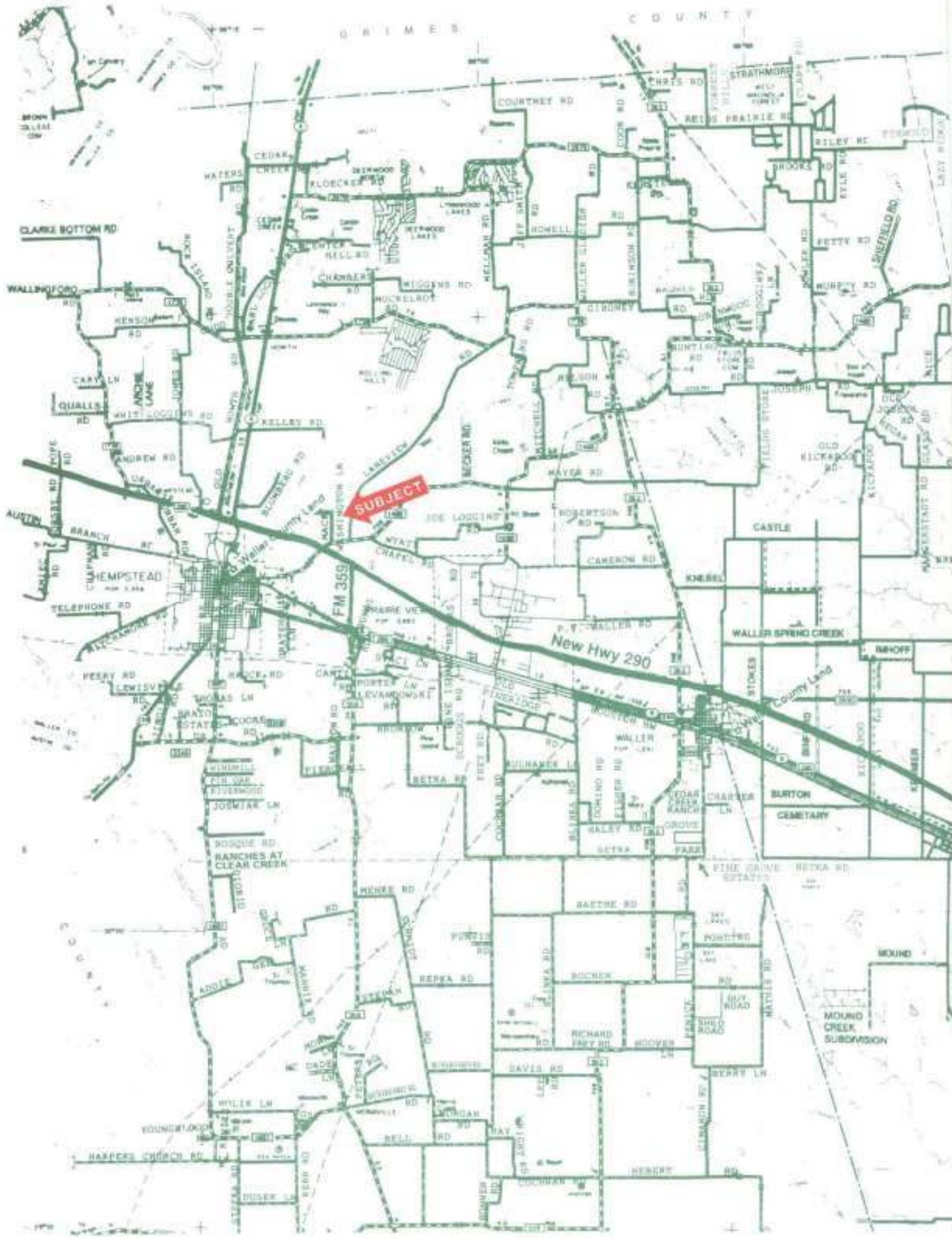

SUBJECT

New Hwy 290

FM 359

County Land

BURTON CEMETARY

BECKA RD

MOUND

MOUND CREEK SUBDIVISION

BERRY LN

HERBERT

COLEMAN

WATKINS

WATKINS

HUSSEY

YOUNGWOOD

HARRIS CHURCH RD

# WALLER COUNTY, TEXAS ISAAC DONOHO SURVEY (A-121)

Scale 1" = 400'  
January 22, 2003



*J.M. Tompkins*  
(45 Acres)  
Volume 66, Page 595  
Deed Records

(Basis of Bearing - Record Deed Call)  
S 89°55'34"E 1594.75'

N 89°56'45"E  
669.18'

**5.000 Acres**

**ISAAC DONOHO SURVEY  
(A-121)**

**B.B. & C.R.R.  
SURVEY  
NO. 5  
(A-88)**

12 Ac



*Jutta Kucumba, et ux*  
(Remaining part of an original 86.456 acre tract)  
Volume 744, Page 464  
Waller County Official Public Records

21 ACRES

40 ACRES

SUBJECT

N 00°23'55"W 654.17'

Mack Washington Lane

Laneview Road

**LEGEND**

- 3/8" Iron Rod found with plastic cap stamped "Rau 4173"
- ⊙ 3/8" Iron Rod set with plastic cap stamped "Rau 4173"
- 1/2" Iron Rod found as called for in record deed
- Survey Line
- x-x- Wire Fence
- ( ) Record Deed Calls

*Carl W. Tompkins*  
(40 Acres)  
Volume 516, Page 707  
Official Public Records

**Notes**

- (1) This property is shown to be outside the flood hazard areas according to FIRM No. 480640 0050 B, effective date December 18, 1986.
- (2) Property description to accompany this plat.